

# ComfoClassic

## Facepiece Components

### FACEPIECE BLANK

Part No. Description

807886 SMALL, BLACK, SILICONE

807878 SMALL, BLACK, HYCAR

807885 MEDIUM, BLACK, SILICONE

807876 MEDIUM, BLACK, HYCAR

807887 LARGE, BLACK, SILICONE

807880 LARGE, BLACK, HYCAR

### YOKE ASSEMBLY

Part No. Description

807607 SMALL, BLACK

807605 MEDIUM, SILVER

807608 LARGE, GOLD

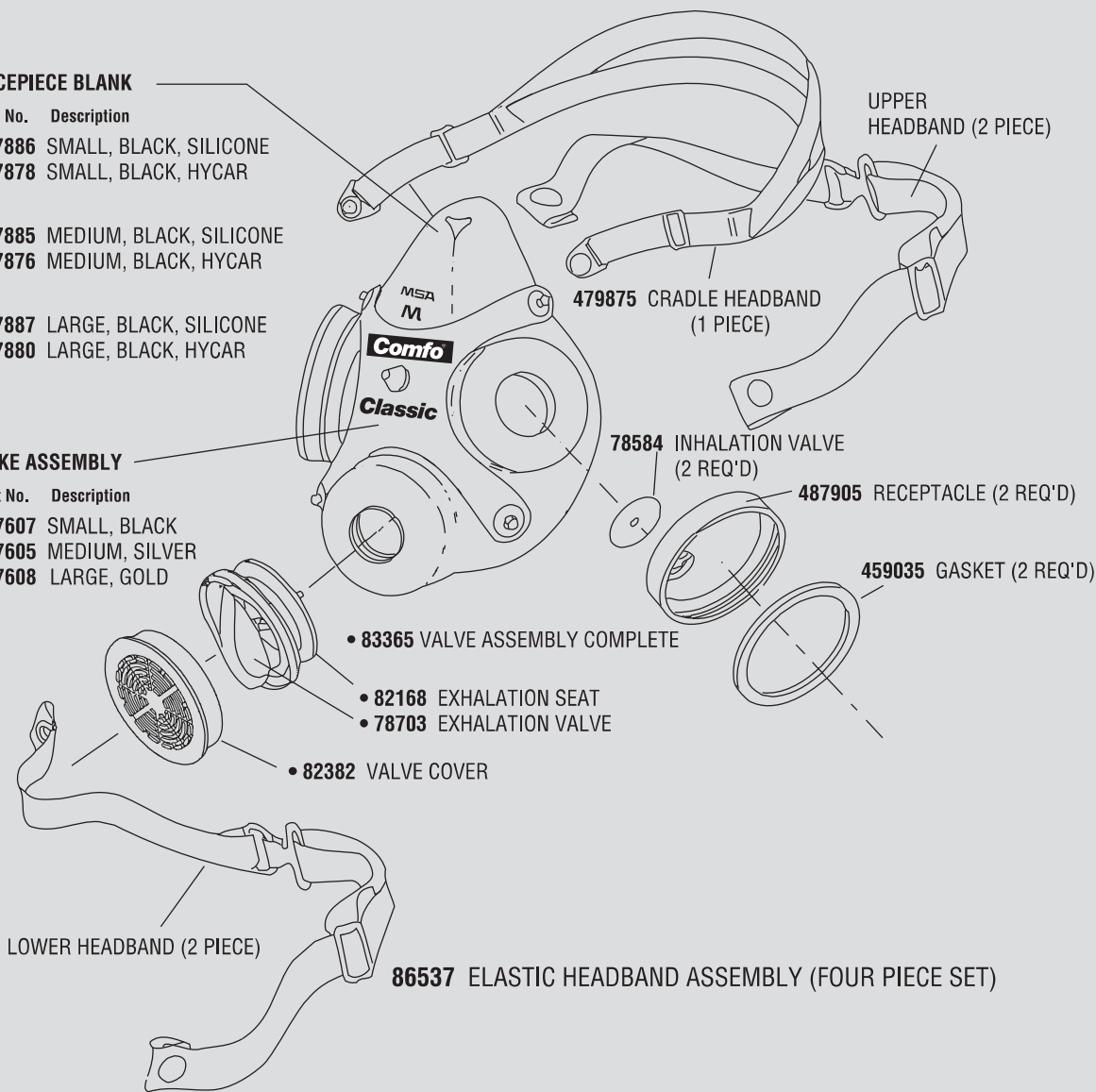

UPPER HEADBAND (2 PIECE)

479875 CRADLE HEADBAND (1 PIECE)

78584 INHALATION VALVE (2 REQ'D)

487905 RECEPTACLE (2 REQ'D)

459035 GASKET (2 REQ'D)

• 83365 VALVE ASSEMBLY COMPLETE

• 82168 EXHALATION SEAT

• 78703 EXHALATION VALVE

• 82382 VALVE COVER

LOWER HEADBAND (2 PIECE)

86537 ELASTIC HEADBAND ASSEMBLY (FOUR PIECE SET)

**Note:** This bulletin contains only a general description of the products shown. While uses and performance capabilities are described, under no circumstances shall the products be used by untrained or unqualified individuals and not until the product instructions including any warnings or cautions provided have been thoroughly read and understood. Only they contain the complete and detailed information concerning proper use and care of these products.



#### MSA Corporate Center

1000 Cranberry Woods Drive  
Cranberry Township, PA 16066 USA  
Phone 724-776-8600

[www.MSAafety.com](http://www.MSAafety.com)

#### U.S. Customer Service Center

Phone 1-800-MSA-2222  
Fax 1-800-967-0398

#### MSA Canada

Phone 1-800-672-2222  
Fax 1-800-967-0398

#### MSA Mexico

Phone 011 52 442 227.3949  
Fax 011 52 442 227 3943

#### MSA International

Phone 724-776-8626  
Toll Free 1-800-672-7777  
FAX 724-741-1559

**MSA**  
The Safety Company

ID 1002-01-MC / Dec 2013

© MSA 2013. Printed in U.S.A.

[www.MSAafety.com](http://www.MSAafety.com)